

BE MONOBLOCK AUTOMATIC BOX FORMER / ERECTOR



DESCRIPTION

The BE MONOBLOCK is a high-speed, compact-size carton erecting machine, fitted with a powered magazine and bottom flaps sealer.

Folded boxes are picked from the magazine by a vacuum cups system which unfolds them and sets them ready for forming. The case is carried along the unit for a fast folding of the bottom flaps, and is set ready for filling and further top sealing.

CONTROL PANEL

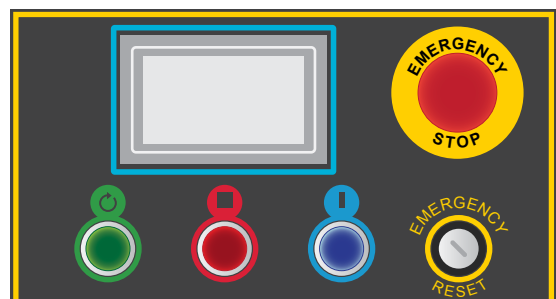

FEATURES

- Fully Automatic System for Erection and Bottom Flaps Folding
- Carton Width, Height and Length Adjustment
- In-built Air Filtering and Lubricating System
- Pressure Gauge with Flow Regulator
- Independent Speed Adjustment for Forming and Exit
- Siemens PLC Control
- Right- or Left-Hand Out-feed Alternatives
- Manually Adjustable Case Dimensions by Means of Cranked Handle, Fitted with Digits Display for Fast Operation
- Automatic Operation for Continuous Output of Cases or Manual Override for Single Delivery
- Height Adjustable Legs

SPECIFICATIONS

- Output up to 1000 Cases/Hour (Depending on Format)
- Power: 220VAC or 380VAC
- Power Consumption: Maximum 1kW
- Air Pressure: 6 Bar
- Air Consumption: 30 Litres/Case
- Working Height: 520-750mm
- Case Magazine Capacity: Approximately 150 Cases (Depending on Wall Thickness)
- Format Changeover: 3 to 5 Minutes

Model	Carton Size					
	Width		Length		Height	
	Min.	Max.	Min.	Max.	Min.	Max.
BE2	120mm	310mm	210mm	450mm	100mm	500mm
BE3	200mm	410mm	300mm	650mm	130mm	600mm
BE4	300mm	510mm	300mm	750mm	160mm	650mm

DIMENSIONS

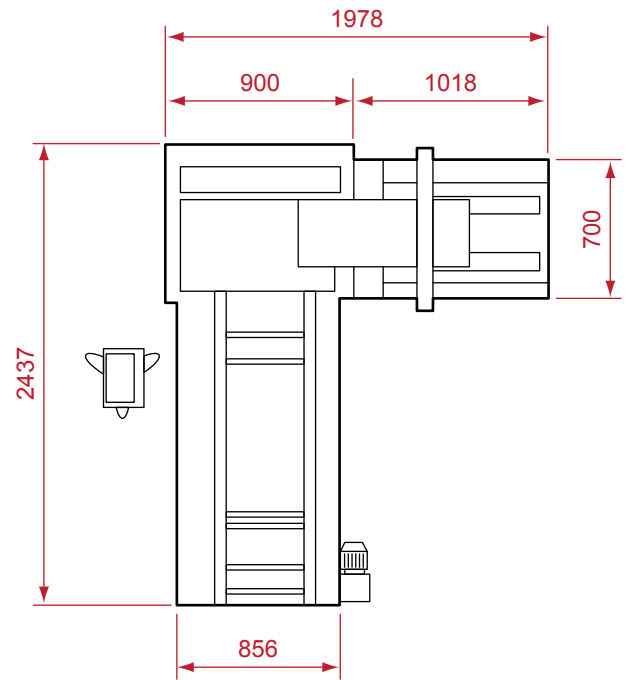

TOP VIEW

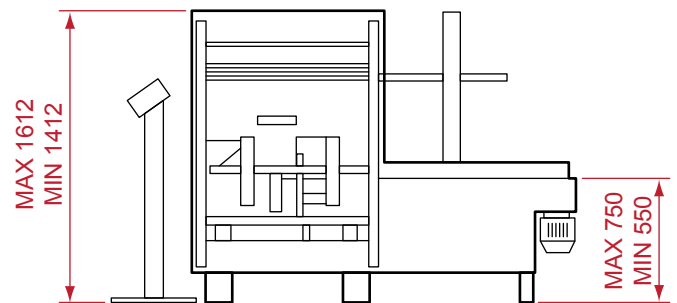

FRONT VIEW

OPTIONS

- Roller Bed Extensions of Different Sizes, Fitted with Bottom Flaps Retaining Plough
- Safety Fences
- Braked Castors for Legs
- Other Versions for Different Sized Cartons
- Explosion Proof Version
- Stainless Steel and Galvanized Versions
- Hot Melt Equipment